

SECOND AMENDMENT TO THE RULES AND REGULATIONS
OF THE VILLAS HOMEOWNERS' ASSOCIATION, INC.
A CORPORATION NOT-FOR-PROFIT

VILLAS HOMEOWNERS' ASSOCIATION, INC., a Florida corporation (hereinafter referred to as the "Association") and pursuant to Paragraph 10. of the BY-LAWS OF VILLAS HOMEOWNERS' ASSOCIATION, INC. (hereinafter referred to as "By-Laws" recorded in O.R. book 935, Page 1803, and VILLAS HOMEOWNERS' ASSOCIATION, INC. recorded in O.R. book 935, Page 1828 (hereinafter referred to as "Rules and Regulations") as amended from time to time, of the Public Records of Leon County, Florida, hereby amends the Villas Homeowners' Association, Inc. Rules and Regulations adding the following paragraph 13. to the Rules and Regulations of the Association:

13. Parking and Parking Spaces. The Association Board of Directors shall designate two (2) parking spaces for each living unit Exhibit "C - A" and Exhibit "C - a 2" (Site Plan Villas Court Southeast). The Association shall maintain a permanent record of those designations available for inspection at reasonable times and places. It shall be incumbent upon the occupants of and visitors to each living unit to determine the parking spaces so designated and they shall utilize the designated parking spaces and no others. Parking on the grass and so as to block the driveways is prohibited.

The original Rules and Regulations of the Association as previously amended shall in all respects remain in full force and effect except to the extent that they are in conflict with this Second Amendment in which case this Second Amendment shall control.

Adoption Date:

This amendment pursuant to Association Corporate Documents on the 4th day of December 2001.

Adoption Method: This amendment pursuant to Association Corporate Minutes on the 15th day of November 2001.

Submission Date:

This amendment was submitted to Leon County on the 5 day of October 2021.

Site Plan

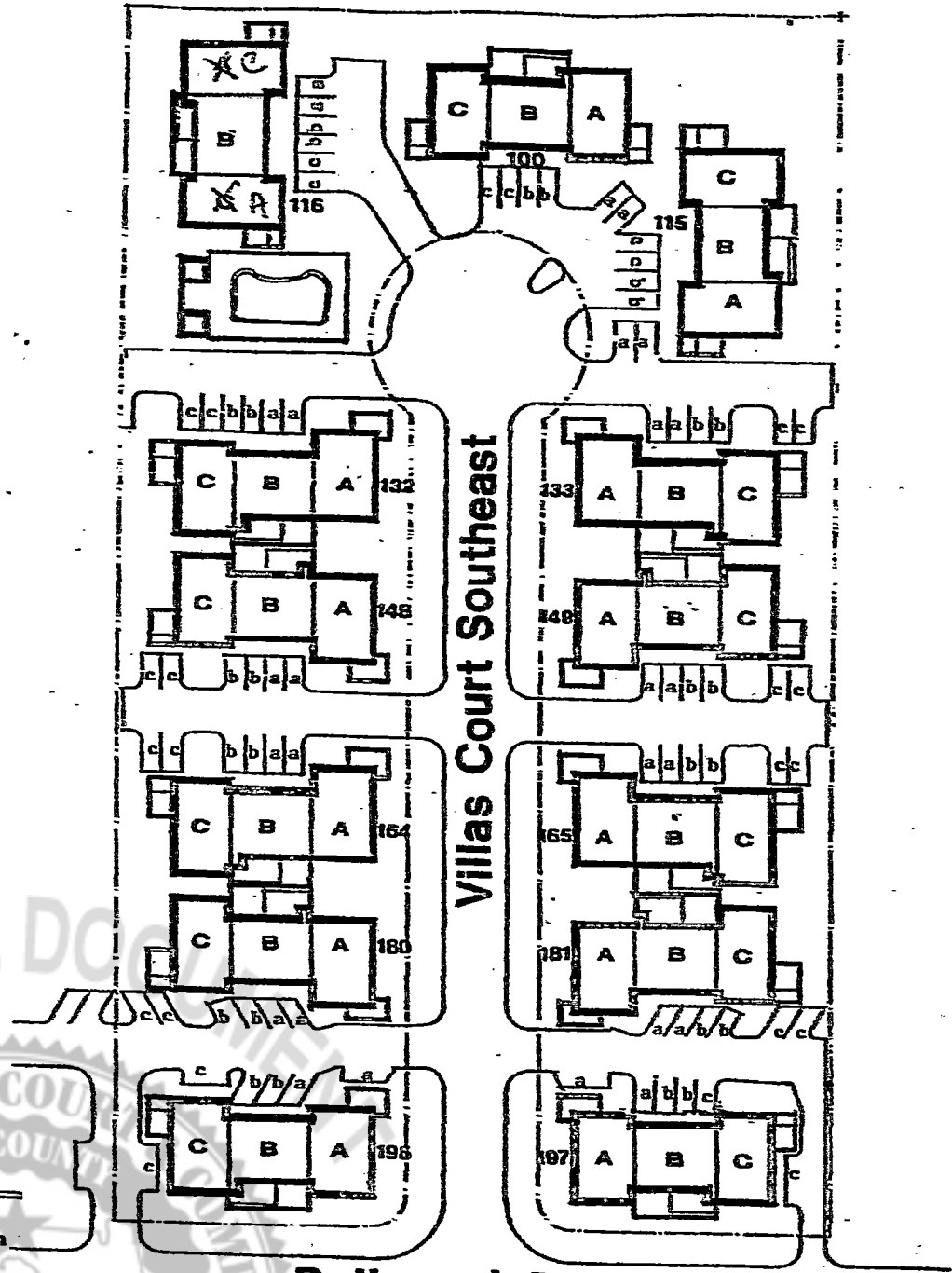

Villas Court Southeast

Dellwood Drive



The
Villas

EXHIBIT C-A

UNOFFICIAL DOCUMENT

CLERK OF THE CIRCUIT COURT
 LEON COUNTY
 GWEN MARSHALL

See EXHIBIT "C-a" which gives a diagram of assigned parking spaces.

Starting at the Cul-de-Sac on the Southeast with building 115, Unit A has 2 parking spaces facing East, parallel with the Unit. Unit B has 2 spaces facing the unit and Unit C has 2 spaces facing the unit.

At building 100, starting in the SE, Unit A has 2 parking spaces facing SE, diagonally between buildings 100 & 115. Unit B has 2 spaces facing the building and Unit C has 2 spaces facing the building.

At building 116, which is facing South, all six parking spaces face the building.

Starting to the South of SE Villas Ct. and going South at buildings 133, 149, 165 and 181, A unit owners will get the first 2 spaces facing the building, B Unit owners the next 2 and C unit owners the last 2. All spaces face the building.

Starting at the North side of SE Villas Ct. and going North, buildings 132, 148, 164 and 180, A unit will get the first 2 spaces, B unit the next 2 and C unit owners the last 2 spaces. All spaces face the building.

At building 197, (which backs up to Dellwood and is South of SE Villas Ct.), A unit has 1 space parallel with the patio and 1 facing the building, B unit has 2 facing the building and C unit has 1 facing the building and 1 parallel with the South side of the building.

At building 196, (which also backs up to Dellwood but is North of SE Villas Ct.), A unit has 1 space parallel to the patio and 1 space facing the building, B unit has 2 spaces facing the building. C Unit has 1 space parallel to the front of the unit and 1 space parallel to the North side of the building.

Exhibit C-a2

